



Spare parts for the professional sector: Coffee grinders



Suitable for:

ARISTARCO



This catalogue is automatically generated.
Therefore, the sequence of the items might
not be always shown at best.
Updates will be issued in case of additions
and/or amendments.

Suitable universal spare parts may not be included





GRINDER ASSEMBLY EMA75

EMA75

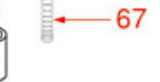
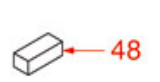
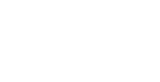
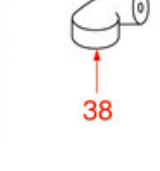
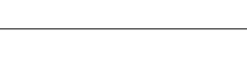
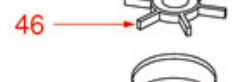
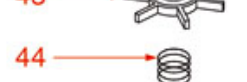
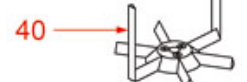
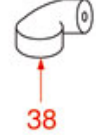
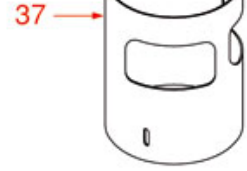
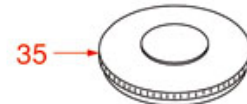
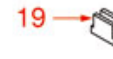
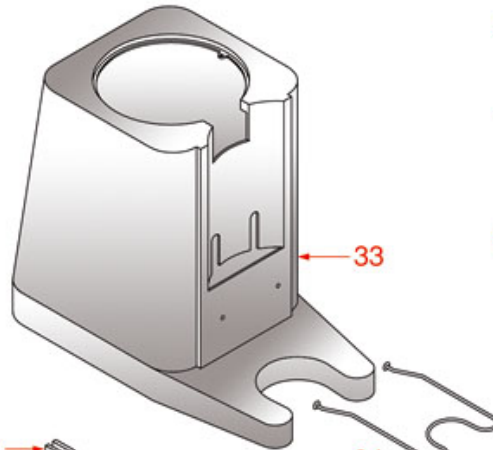
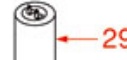
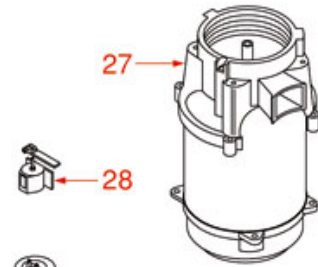
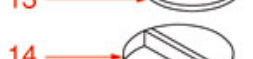
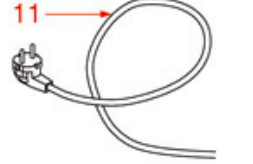
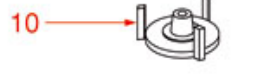
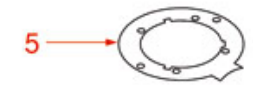
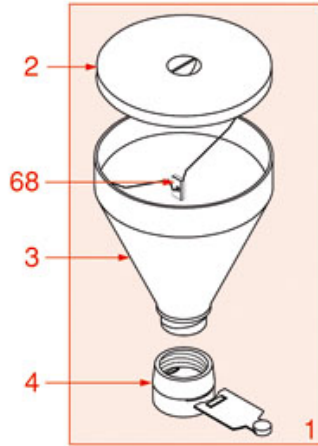



ARISTARCO



Position	LF code no.	Description
9	1251018	GRINDING BURRS ARISTARCO (PAIR) RIGHT
16	1319163	RED SINGLE POLE PUSH-BUTTON 250V 2A
17	3240123	MICROSWITCH ROLD VRSRB1DA1
18	3240123	MICROSWITCH ROLD VRSRB1DA1
20	3319012	BIPOLAR SWITCH GREEN 16A 250V
25	1252079	RING-RETAINING PIN
29	3068080	CAPACITOR ELECTRICAL 10 μ F
35	1252078	DOSER LID
36	1252100	DOSER CYLINDER
44	1250063	STAR SPRING
54	1250067	DOSER LEVER RETURN SPRING



GRINDER ASSEMBLY EMA80

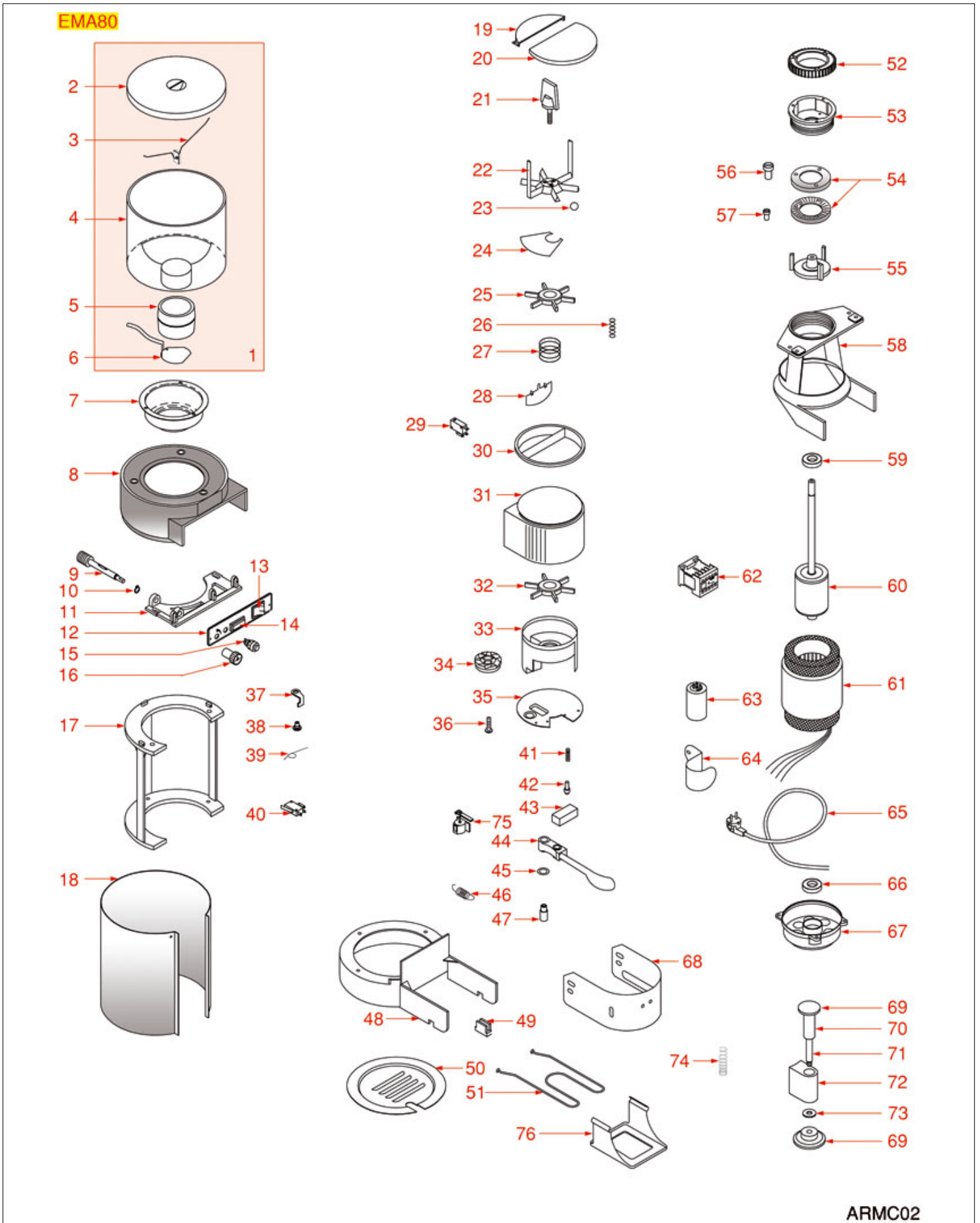



ARISTARCO



Position	LF code no.	Description
13	3319012	BIPOLAR SWITCH GREEN 16A 250V
15	1319163	RED SINGLE POLE PUSH-BUTTON 250V 2A
27	1250063	STAR SPRING
29	3240123	MICROSWITCH ROLD VRSRB1DA1
40	3240123	MICROSWITCH ROLD VRSRB1DA1
46	1250067	DOZER LEVER RETURN SPRING
54	1251007	GRINDING BURRS ARISTARCO-GAGGIA(PAIR) RH
54	1251014	GRINDING BURRS ARISTARCO-GAGGIA(PAIR) RH
54	1251018	GRINDING BURRS ARISTARCO (PAIR) RIGHT
59	1063911	BEARING 6202 ZZ NSK
63	3068080	CAPACITOR ELECTRICAL 10 μ F
66	1063911	BEARING 6202 ZZ NSK



GRINDER ASSEMBLY SE/N

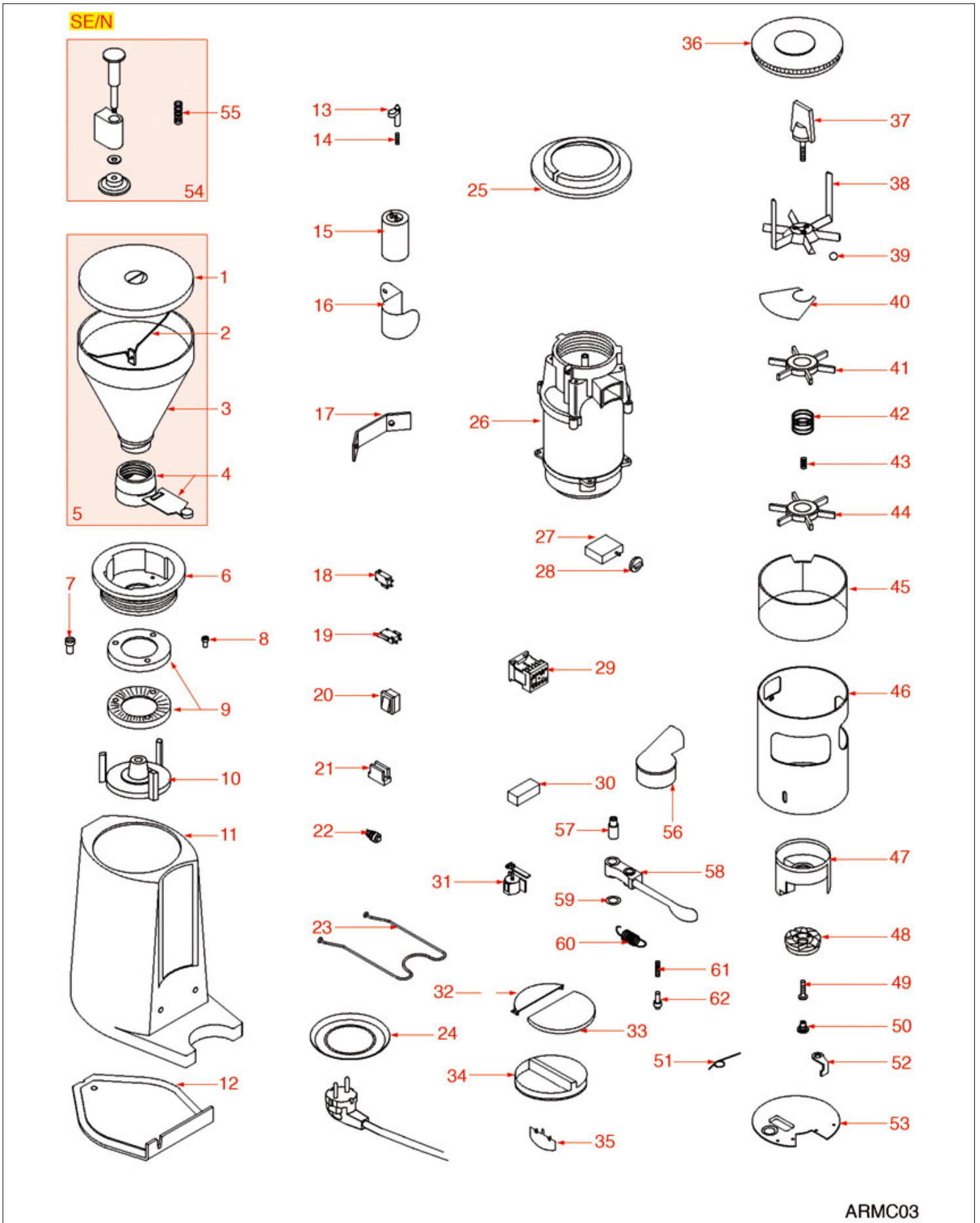

ARMC03

Positions without LF code no.: upon request



ARISTARCO



Position	LF code no.	Description
9	1251018	GRINDING BURRS ARISTARCO (PAIR) RIGHT
13	1252079	RING-RETAINING PIN
15	3068016	CAPACITOR DUCATI ENERGIA 10 μ F
18	3240123	MICROSWITCH ROLD VRSRB1DA1
19	1240016	MICROSWITCH HONEYWELL V5B010CB3E
20	3319012	BIPOLAR SWITCH GREEN 16A 250V
22	1319163	RED SINGLE POLE PUSH-BUTTON 250V 2A
36	1252078	DOSER LID
42	1250063	STAR SPRING
45	1252100	DOSER CYLINDER
60	1250067	DOSER LEVER RETURN SPRING



Suitable for:



Suitable for:

Bearings

1063911 BEARING 6202 ZZ NSK
external \varnothing 35 mm-internal \varnothing 15 mm-thickness 11 mm



ARISTARCO 714

Capacitors, electrical

3068016 CAPACITOR DUCATIENERGIA 10 μ F
450V 50/60Hz
operating temperature -25 + 85°C
lead connector 6.35x0.8 mm
 \varnothing 36xh58 mm



ARISTARCO 166

3068024 CAPACITOR DUCATIENERGIA 16 μ F
450V 50/60Hz
operating temperature -25 + 85°C
lead connector 6.35x0.8 mm
 \varnothing 36xh70 mm



ARISTARCO 2036

3068080 CAPACITOR ELECTRICAL 10 μ F
450V 50/60Hz - \varnothing 30xh71 mm



ARISTARCO 166

3068083 CAPACITOR ELECTRICAL 16 μ F
450V 50/60Hz - \varnothing 35xh71 mm



ARISTARCO 2036

Dosers for coffee

1252100 DOSER CYLINDER
for Grinder-dispenser (ARISTARCO) EMA75 - SE/N



ARISTARCO 719

1252078 DOSER LID
for Grinder-dispenser (ARISTARCO) EMA75 - SE/N

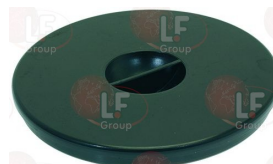

ARISTARCO 718

Feet

1313006 FOOT \varnothing 19x10 mm



ARISTARCO 1046



Grinders

1251018 GRINDING BURRS ARISTARCO (PAIR) RIGHT
 external \varnothing 64 mm - internal \varnothing 37 mm
 thickness 8.5 mm - 3 fixing holes
 for Grinder-dispenser (ARISTARCO) EMA75 - EMA80
 SE/N



ARISTARCO 70111

1251006 GRINDING BURRS ARISTARCO-GAGGIA (PAIR) RH
 external \varnothing 58 mm - internal \varnothing 34 mm
 thickness 8 mm - 3 mounting holes



ARISTARCO 70110

1251007 GRINDING BURRS ARISTARCO-GAGGIA (PAIR) RH
 external \varnothing 84 mm - internal \varnothing 45 mm
 thickness 9 mm - 3 mounting holes
 for Grinder-dispenser (ARISTARCO) EMA80



ARISTARCO 70113

1251014 GRINDING BURRS ARISTARCO-GAGGIA (PAIR) RH
 external \varnothing 74 mm - internal \varnothing 42.5 mm
 thickness 9 mm - 3 fixing holes
 for Grinder-dispenser (ARISTARCO) EMA80



ARISTARCO 70112

Indicator lights

3221042 GREEN INDICATOR LAMP 230V
 head \varnothing 20 mm - hole \varnothing 10 mm - 120°C
 wires connection length 200 mm



ARISTARCO 1083

Ironmongery (screws,nuts,washers)

1528009 HEXAGON HEAD SCREW M6x12
 inox - UNI 5739 - DIN 933 - ISO 4017



ARISTARCO 52

3528143 HEXAGON NUT M5 BLIND
 stainless steel - altezza 11 mm - UNI 5721 - DIN 1



ARISTARCO 1013



Suitable for:

ARISTARCO



Suitable for:

Microswitches, mechanical

1240017 MICROSWITCH CROUZET U83161.1
10A 250V



ARISTARCO 1689

1240016 MICROSWITCH HONEYWELL V5B010CB3E
16A 250V
for Grinder-dispenser (ARISTARCO) SE/N



ARISTARCO 925

3240123 MICROSWITCH ROLD VRSRB1DA1
16A 250V



ARISTARCO 833

O-Ring and ORM gaskets

1186397 O RING GASKET OR 02300 EPDM

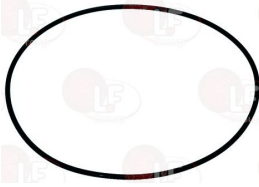

ARISTARCO 10399

1186223 O-RING 02056 EPDM



ARISTARCO 6456

1186693 O-RING 04325 EPDM



ARISTARCO 5206

Pins

1252079 RING-RETAINING PIN



ARISTARCO 708



Springs

1250067 DOSER LEVER RETURN SPRING
for ARISTARCO EMA75-EMA80-SE/N



ARISTARCO 741

1250063 STAR SPRING
for ARISTARCO EMA75-EMA80-SE/N



ARISTARCO 733

Switches

3319012 BIPOLAR SWITCH GREEN 16A 250V
16(4)A 250V - max. temperature 120°C
with indicator lamp and push-button cap
mounting hole 22x30 mm - silk screen print 0 - I



ARISTARCO 2496

ARISTARCO 364

3319780 BLOCK CONNECTION WHITE 22x30 mm



3319779 BLOCK CONNECTIONS BLACK 22x30 mm



3319782 FRAME SAFETY 2 SIDES BLACK 22x30 mm



3319783 FRAME SAFETY 4 SIDES BLACK 22x30 mm



3319501 PUSH-BUTTON PROTECTION CAP
external dimensions 29x36 mm
for switches with mounting hole 22x30 mm



3319088 BIPOLAR SWITCH ORANGE 16A 250V
16(4)A 250V - max. temperature 120°C
with indicator lamp and push-button cap
mounting hole 22x30 mm

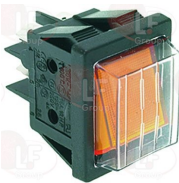

ARISTARCO 1146

3319780 BLOCK CONNECTION WHITE 22x30 mm





Suitable for:

3319779 BLOCK CONNECTIONS BLACK 22x30 mm



ARISTARCO



Suitable for:

3319782 FRAME SAFETY 2 SIDES BLACK 22x30 mm



3319783 FRAME SAFETY 4 SIDES BLACK 22x30 mm



3319501 PUSH-BUTTON PROTECTION CAP
external dimensions 29x36 mm
for switches with mounting hole 22x30 mm



1319163 RED SINGLE POLE PUSH-BUTTON 250V 2A
for Grinder-dispenser (ARISTARCO) EMA75 - EMA80 SE/N



ARISTARCO 809

1319082 SINGLE-POLE PUSH BUTTON 16A 250V



ARISTARCO 4322

Terminal blocks

3247004 TERMINAL BLOCK 3-POLE CERAMIC
for cable 1.5-4 mm²
operating temperature 300°C
nominal voltage 250V
dimensions 33x18x15 mm



ARISTARCO

3247007 TERMINAL BLOCK 3-POLE CERAMIC
for cable 1.5-4 mm²
operating temperature 300°C
nominal voltage 250V
dimensions 38x25x20 mm



ARISTARCO 120

Timers

3446151 TIMER 5 MINUTES C20
manually set mechanical timer
manually set cycle 5 minutes
2 poles with contact capacity 16(3)A 250V
max temperature 125°C
D-shaped pin \varnothing 6x4.6 mm

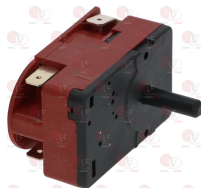

ARISTARCO 1089

3241161 BLACK KNOB \varnothing 40 mm
D shaft hole 6x4.6 mm



ARISTARCO 3345

ARISTARCO 621

The data herewith contained may change without notice and LF SpA cannot be held responsible for possible errors stated or resulting by the use of this document. All rights reserved. No part of this publication may be reproduced without written permission by LF SpA.



Distributing Components, Spare Parts & Accessories in original quality worldwide

-
- LF SpA HEADQUARTERS**
via Voltri, 80 - 47522 Cesena (FC) ITALY
Tel. +39 0547 34 11 11 - Fax +39 0547 34 11 10
www.lfircambi724.it - info@lfircambi.it
Export Dept. Tel. +39 0547 34 11 50 - Fax +39 0547 34 11 55
www.lfspareparts724.com - export@lfspareparts.com
- LF SpA HOUSEHOLD COMPONENTS DIVISION**
Via Padriciano, 99 - AREA Science Park - 34149 Trieste (TS) ITALY
Tel. +39 0547 34 12 42 - Fax +39 0547 34 12 48
www.lfspareparts724.com - info@lfspareparts.com
- EPGC Sas FRANCE**
13, Rue des Forts - 59960 Neuville en Ferrain
Tel. +33 (0)3 20 25 06 21 - Fax +33 (0)3 20 25 34 12
www.epgc.com - epgc@epgc.com
- LF GmbH GERMANY**
Junkersstrasse, 3 - D-82178 Puchheim - München
Tel. +49 89 89 45 78 66 - Fax +49 89 89 45 78 88
www.lfersatzteile724.de - info@lfersatzteile.de
- LF China REPUBLIC OF CHINA**
Room 403, No.2, Huadu Mansion, Lane 422, Huanghua Rd.
Minhang Dist. - 201103 Shanghai
Tel. +86 (0)21 33 53 66 31 - Fax +86 (0)21 33 53 66 32
www.lfspareparts724.com - china@lfspareparts.com
- OOO LF RUSSIAN FEDERATION**
Ul. Anatoliya Zhivova, 8 - office 1 - 123100 Moscow
Tel./Fax +7 495 725 26 53
www.lfspareparts724.ru - info@lfspareparts.ru
- LF Repuestos Horeca S.L.U. SPAIN**
Poligono Industrial Carpetania - C/Miguel Faraday, 8 - 28906 Getafe
Tel. +34 91 477 91 00 - Fax +34 91 477 90 81
www.lfrepuestos-horeca724.es - info@lfrepuestos.es
- LF Scandinavia Aps - LF Spareparts S.p.A. DENMARK**
Nupark, 51 - 7500 Holstebro
Tel. +45 70 70 77 33
www.lfspareparts724.dk - denmark@lfspareparts.dk
- LF SpA Cesena (IT) Swiss Branch Steinhausen SWITZERLAND**
Sennweidstrasse, 45 - CH-6312 Steinhausen
Tel. +41 (0)41 760 15 80/1 - Fax +41 (0)41 760 15 85
www.lfersatzteile724.ch - info@lfersatzteile.ch
- LF Spare Parts Ltd. UNITED KINGDOM**
A10a Lakeside Business Park, Broadway Lane
South Cerney, Gloucestershire GL7 5XL
Tel. +44 (0)1285 86 16 25 - Fax +44 (0)1285 86 39 49
www.lfspareparts724.co.uk - info@lfspareparts.co.uk
- LF Central Est Europe S.r.o. CZECH REPUBLIC**
Antala Staska 1859/34
14000 Praha 4 - KRC
Tel. +420 730 156 910
www.lfspareparts724.cz - info@lfspareparts.cz
- LF SPARE PARTS INC. USA**
Legal address:
155 Office Plaza Dr - Suite A - Tallahassee, FL 32301
Business/Mailing address:
1100 South Tower, 225 Peachtree St., N.E. - Atlanta, GA 30303, USA
Tel. +1-404-525-2600 - Fax +1-404-586-3528
www.lfspareparts724.us - info@lfspareparts.us
Tel. West Coast and Midwest: 206-349-1525 Sauro
Tel. East Coast and the Caribbean: 786-817-1764 Luis
-
- AUSTRALIA AND NEW ZEALAND**
www.lfspareparts724.com
andrea.calvio@lfspareparts.com
- AUSTRIA**
www.lfersatzteile724.at
info@lfersatzteile.at
- BALKAN COUNTRIES**
www.lfspareparts724.com
matija.ramov@lfspareparts.com
- BALTIC COUNTRIES**
www.lfspareparts724.com
inara.silina@lfspareparts.com
- LATIN AMERICA AND THE CARRIBEANS**
www.lfrepuestos-horeca724.es
export@lfrepuestos.es
- POLAND**
www.lfspareparts724.pl
info@lfspareparts.pl
- SOUTH KOREA**
www.lfspareparts724.com
fabio.doni@lfspareparts.com
- TURKEY**
www.lfyedekparca724.com
export@lfspareparts.com